

Disc brakes

Technical datas and dimensions

Flexible coupling disc association

Flexible coupling **SDD** series
 Ventilated discs thickness 30-42mm
 Disc mounting and dismounting without
 moving the machines back

- Rubber element Vkr (red)
- Rubber element Vk60D (yellow)
 (specify type of rubber element with order)

- Option:**
- Long hub SDDL

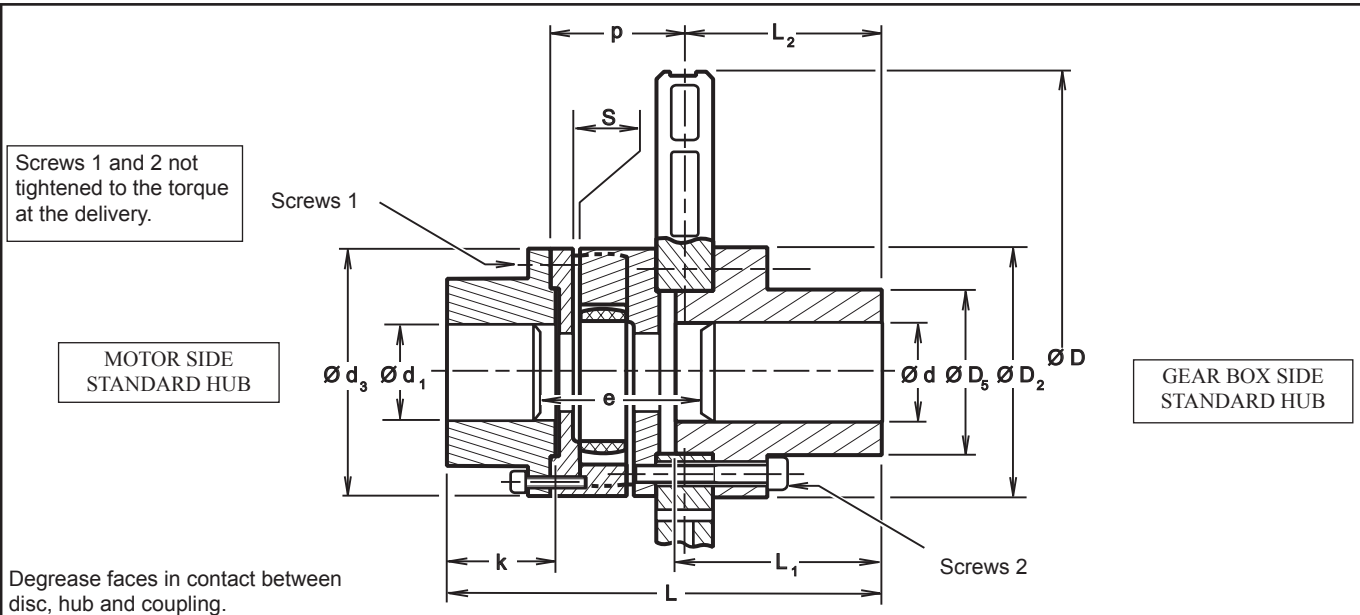

Designation		Disc	315V30	355V30	395V30	445V30	495V30	550V30	625V30	705V30	795V30	625V42	795V42	995V42			
Flexible coupling SDD			125	145	170	170	230	230	260	260	300	300	400	400			
Assembly	J	kg.m ²	0.159	0.260	0.403	0.632	1.204	1.516	2.686	4.48	7.046	3.83	10.15	23.6			
	Weight	kg	21.3	30	39	48.5	96	102	126	138	240	228	283	383			
	For use with calipers		650-5	650-5 645	650-5 645	650-5 645	650-5 645-4	650-5 645-4-3	650-5 645-4-3	4-3	4-3	2	2	2			
	Maximum speed	r.p.m.	3 000	2 700	2 400	2 100	1 800	1 800	1 500	1 300	1 200	1 400	1 000	900			
	L	mm	232.5	248.5	266	299	352.5	352.5	371.5	371.5	401.5	413.5	470.5	470.5			
Tolerance on S and L		mm	+3	+3	+3	+3	+3.5	+3.5	+4	+4	+4	+4	+4	+4			
Disc	D	mm	315	355	395	445	495	550	625	705	795	625	795	995			
	D ₂	mm	125	145	165	175	220	220	235	265	300	300	380	380			
	D ₅	mm	80	95	105	110	150	150	150	180	210	210	260	260			
	L ₂	mm	102	102	102	135	135	135	135	135	135	141	141	141			
	L ₁	mm	107	107	107	140	140	140	140	140	140	140	140	140			
	d (pilot bore)	mm	-	-	-	-	-	-	-	-	-	40	40	40			
	d max keyed or shrink fit	mm	50	60	70	70	100	100	100	120	130	140	180	180			
Coupling	d ₃	mm	125	145	170	170	230	230	260	260	300	300	400	400			
	e min	mm	69.5	81	84.5	84.5	102.5	102.5	119	119	130	130	158.5	158.5			
	k	mm	56	60.5	74.5	74.5	110	110	112.5	112.5	131.5	131.5	172	172			
	p	mm	76	87.5	91	91	110	110	126.5	126.5	137.5	143.5	160	160			
	d ₁ max keyed	mm	53	60	75	75	110	110	125	125	140	140	160	160			
	S	mm	5	5	5	5	7	7	8	8	8	8	8	8			
	Max torque Cp	Rubber element Vkr	750	1 200	1 900	1 900	5 150	5 150	7 950	7 950	11 700	11 700	26 700	26 700			
	in Nm	or Vk60D	1 110	1 800	2 850	2 850	7 740	7 740	11 940	11 940	17 550	17 550	40 050	40 050			
	Transmissible torque (Ct)		Ct ≤ Cp/k	k min, temperature						k=3 ≤ 40°C			k=4 < 80°C			k=6 ≤ 80°C	
	(Ct: motor nominal torque)		Cd < Cp	rate						≤ 120starts/h			≤ 240starts/h			≤ 600starts/h	
Tightening torque on screw (1) *		Nm	49	85	85	85	135	135	210	210	425	425	730	730			
Tightening torque on screw (2) *		Nm	49	86	135	210	290	290	410	550	710	710	1 450	1 450			

*: Screws greased under head and on thread.

Cd: motor starting torque

Due to continuous development and improvement, all dimensions and characteristics are subject to change without notice.